

USB 2.0 RG2304GE-LAN
4-Port USB 2.0 Gigabit
Ethernet LAN Extender System

Quick
Start
Guide

www.icronshop.com
sales@icronshop.com
+44 (0)1273 731 555



Before you get started, ensure that all the drivers required for your USB device(s) are installed.

Network Connect

- 1 Place the Local Extender where desired and connect the Cat 5e patch cable from the Link port (RJ45) to a network switch or wall network port connected to a switch.

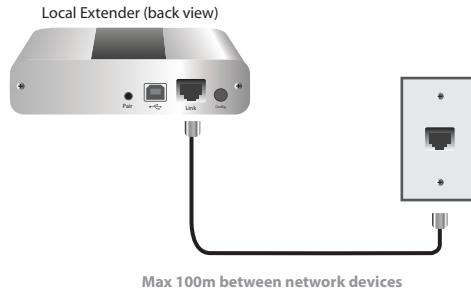

- 2 Connect the Local Extender to the computer using the included USB cable.

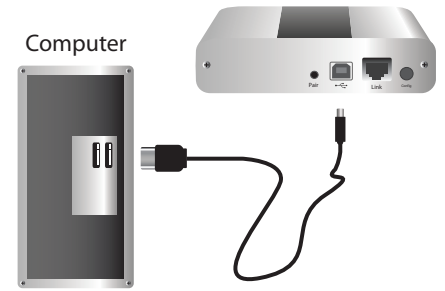

- 3 Place the Remote Extender where desired. Connect the Cat 5e patch cable from the Link port (RJ45) to a network switch or wall network port connected to a switch and connect the Remote Extender to a power source.

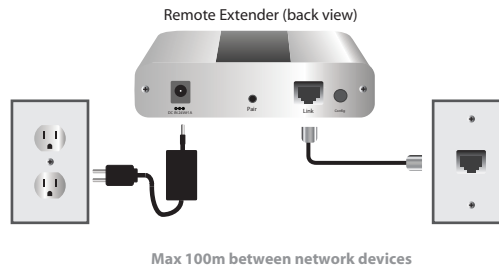

- 4 Attach USB device(s) to the Remote Extender.

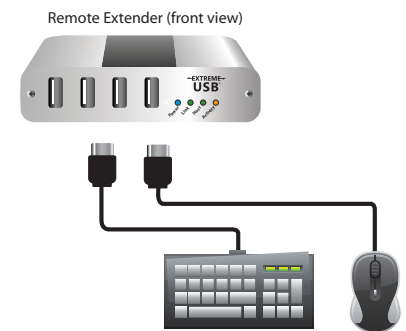

Direct Connect

- 1 Place extenders where desired and connect the Cat 5e extension link cabling to the Link ports (RJ45) on the Local and Remote Extender.



- 2 Connect the Local Extender to the computer using the included USB cable.

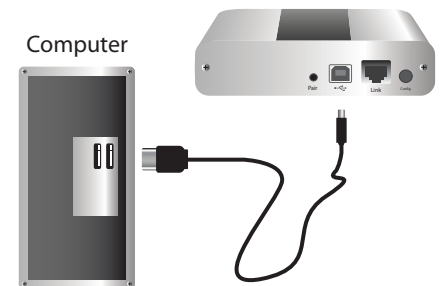

- 3 Connect the Remote Extender to the AC adapter and a power source.



- 4 Attach USB device(s) to the Remote Extender.

